

# Beacon<sup>TM</sup> Richland County, OH

## Summary

**Parcel Number** 0270412113000  
**Location Address** 417 TREMONT ST  
**Legal Description** 5099 47 X 203 417 TREMONT ST  
 (Note: Not to be used on legal documents.)  
**Property Class** R - RESIDENTIAL  
**Land Use** (510) R - SINGLE FAMILY DWELLING, PLATTED LOT  
**Neighborhood** 02704009  
**Tax District** 02704  
**Acres** 0  
**Sec/Twp/Rng** --  
**Township** MANSFIELD  
**School District** MANSFIELD CITY SD  
**Municipality** MANSFIELD  
**Topo** ABOVE STREET  
**Utilities** ALL PUBLIC  
**Roads** PAVED  
**Traffic** LIGHT



027-04-121-13-000 05/12/2016

[View Map](#)

## Owners

**Owner**  
 KOCHHEISER PAULINE  
 & BRUCE E SURV  
**Mailing Address**  
 KOCHHEISER PAULINE  
 417 TREMONT  
 MANSFIELD OH 44903

**Treasurer Code** FORECLOSURE FEE

## Valuation

Assessed Year	2020	2019	2018
Land Value	\$1,560.00	\$1,560.00	\$1,560.00
Building Value	\$6,200.00	\$6,200.00	\$6,200.00
<b>Total Value (Assessed 35%)</b>	<b>\$7,760.00</b>	<b>\$7,760.00</b>	<b>\$7,760.00</b>
Land Value	\$4,460.00	\$4,460.00	\$4,460.00
Building Value	\$17,710.00	\$17,710.00	\$17,710.00
CAUV Value	\$0.00	\$0.00	\$0.00
<b>Total Value (Appraised 100%)</b>	<b>\$22,170.00</b>	<b>\$22,170.00</b>	<b>\$22,170.00</b>

## Taxes Due

Tax Year (click for detail)	1st Half Due	2nd Half Due	Delinquent	Total Due
<a href="#">2020</a>	\$0.00	\$0.00	\$1,767.23	\$1,767.23
<a href="#">2016</a>	\$0.00	\$0.00	\$0.00	\$0.00
<a href="#">2015</a>	\$0.00	\$0.00	\$0.00	\$0.00
<a href="#">2014</a>	\$0.00	\$0.00	\$0.00	\$0.00
<a href="#">2013</a>	\$0.00	\$0.00	\$0.00	\$0.00
<a href="#">2012</a>	\$0.00	\$0.00	\$0.00	\$0.00
<a href="#">2011</a>	\$0.00	\$0.00	\$0.00	\$0.00
<a href="#">2010</a>	\$0.00	\$0.00	\$0.00	\$0.00
<a href="#">2009</a>	\$0.00	\$0.00	\$0.00	\$0.00

## Land

Descr	P	LN	CD	Acres	Frontage	Depth	Base Size	Base Rate	Sq ft.	Incr / Decr	Land-Val
Regular Lot	F	1	1	0.199	45	193	200.00	90	8,685	45 / 90	4,460

**Total Acres:**  
 0.1994  
**Total Land-Value:**  
 4,460

### Residential Improvement Information

Card	1	Bathroom Remodeled	2
Stories	1	Kitchen Remodeled	2
Exterior Wall	FRAME	Total Rooms	5
Style	CAPE COD	Bedrooms	2
Square Feet	772	Full Baths	1
Basement	FULL	Half Baths	0
Heating Fuel Type	GAS	Family Rooms	0
Physical Condition		Additional Fixtures	2
Attic	UNFIN	Total Fixtures	5
Year Built	1930	WBFP Stacks	0
Effective Year	0	Fireplace Openings	0
Year Remodeled	0	Prefab Fireplace	0

### Additions

Card 1

Line	Lower	First	Second	Third	Area	Value
0		Main Building			516	0
1		11 - OFP OPEN FRAME PORCH			84	2,200
2		35 - STOOP STOOP			72	1,200
3		13 - FR GR FRAME GARAGE			216	4,600
4		10 - 1S FR FRAME			256	12,700

### Sales

Date	Book	Page	Grantor	Grantee	Price	Instr Type	Sale Validity	Qualified
9/16/1992			MANLET PAULINE	KOCHHEISER PAULINE	\$0		NOT VALIDATED	Unqualified

### Recent Sales in Area

Sale date range:

From:

12/14/2017

To:

12/14/2020

Sales by Neighborhood

1500

Feet ▼

Sales by Distance

### Pay Property Taxes

Pay Property Tax

### Photos



027-04-121-13-000 05/12/2016



027-04-121-13-000 05/13/2013

Sketches

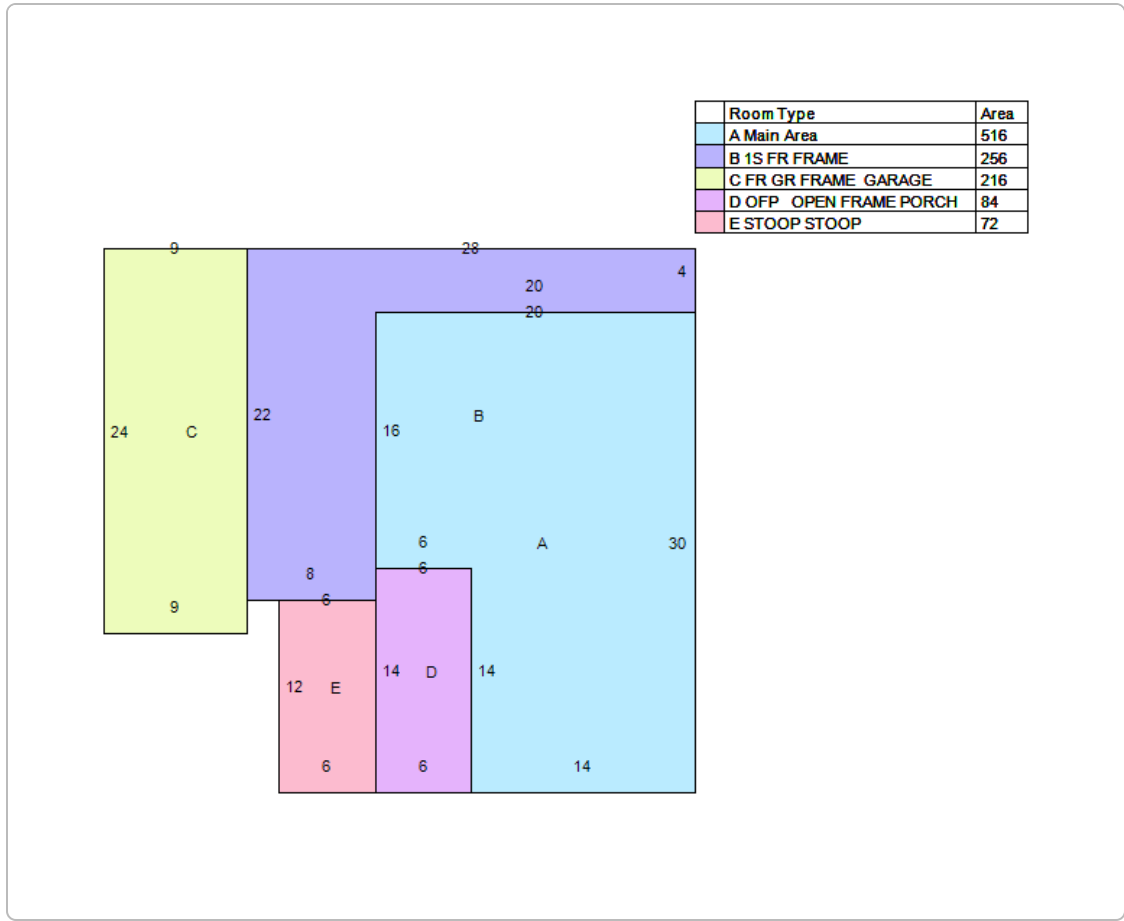

No data available for the following modules: Other Dwelling Features, Commercial Improvement Information, Interior/Exterior Information, Other Buildings & Yard Improvements, Other Features, Permits.

The information displayed on this map is taken from public records, and is intended to be used as a reference. Map information is believed to be accurate, but accuracy is not guaranteed. Richland County makes no warranties, express or implied, concerning the accuracy, completeness, or reliability of this information, and assumes no liability or any other legal responsibility for the information contained on this map. The map does not represent the official survey of the land.

[User Privacy Policy](#)  
[GDPR Privacy Notice](#)

Developed by  
 Schneider  
GEOSPATIAL

Last Data Upload: 12/14/2020, 7:34:06 AM

Version 2.3.98